

BERRYS



Property and Business

Our Ref: CJJ/SER/SA5502

Willow House East
Shrewsbury Business Park
Shrewsbury
Shropshire
SY2 6LG

t: 01743 271 697
f: 01743 271 753

e: enquiries@berrymbros.com
w: www.berrymbros.com

13th May 2010

Dear Sir/Madam

18.80 acres of Land at Ranton, Stafford

Due to the level of interest from prospective purchasers in the above land, both as a whole and in lots, we are instructed to request the submission of best offers.

Prospective purchasers are required to submit their offer in writing **NO LATER THAN 12 NOON ON THURSDAY 20TH MAY 2010**, in a sealed envelope marked "Land at Ranton" to Berrys, Willow House East, Shrewsbury Business Park, Shrewsbury, Shropshire, SY2 6LG.

Any offer should contain the following information:

1. Full name, address and telephone number of the prospective purchaser.
2. Identify on the attached plan the area on which the offer is made.
3. Price offered (amount also to be stated in words).
4. Any conditions which might be attached to the offer.
5. Confirmation whether the purchase is subject to selling a property, raising finance or on a cash basis.
6. Preferred timescale in respect of exchange and completion.
7. Solicitor's details.
8. Any relevant additional information.

Following receipt of offers on 20th May these will be discussed with our client, following which we will respond to you should we need to discuss the offers or details of the boundaries.

We trust that you find the above in order, however should you have any queries or require any additional information please do not hesitate to contact Chris Jones or Sarah Reece at the above office.

Yours faithfully

pp. *S. Reece*

Mrs Sarah E Reece, MRICS, FAAV.

for and on behalf of Berrys

Direct Line: 01743 267068

sarah.reece@berrymbros.com

Partners - M R Anwyl Ltd, A G Bowcock Ltd, N D K Bowman Ltd, A C Farnsworth Ltd, Christopher J Jones Ltd, J P Pridmore Ltd, J C M Stables Ltd
Associates - S J Locke BSc (Hons) MRICS FAAV, Sarah Reece BSc (Hons) MRICS FAAV, A T B Tompson BA (Hons) MRICS
Consultants - G F Allen Ltd, R S Conn FRICS, W A Gray FRICS, G E Holmes FRICS FAAV, G L Jackson FRICS

Kettering Office: 42 Headlands, Kettering, Northamptonshire, NN15 7HR, t: 01536 412 464

Northampton Office: 17 York Road, Northampton, Northamptonshire, NN1 5QG, t: 01604 630 251

Northwich Office: 1 Brunel Court, Rudheath Way, Gadbrook Park, Northwich, Cheshire, CW9 7LP, t: 01606 49 200

Towcester Office: Suite 4, Town Hall, Market Square, Towcester, Northamptonshire, NN12 6BS, t: 01327 359 820



FS 34146

18.80acres (7.61hectares) of Land at Ranton, Near Stafford, Staffordshire (Scale 1:2500)

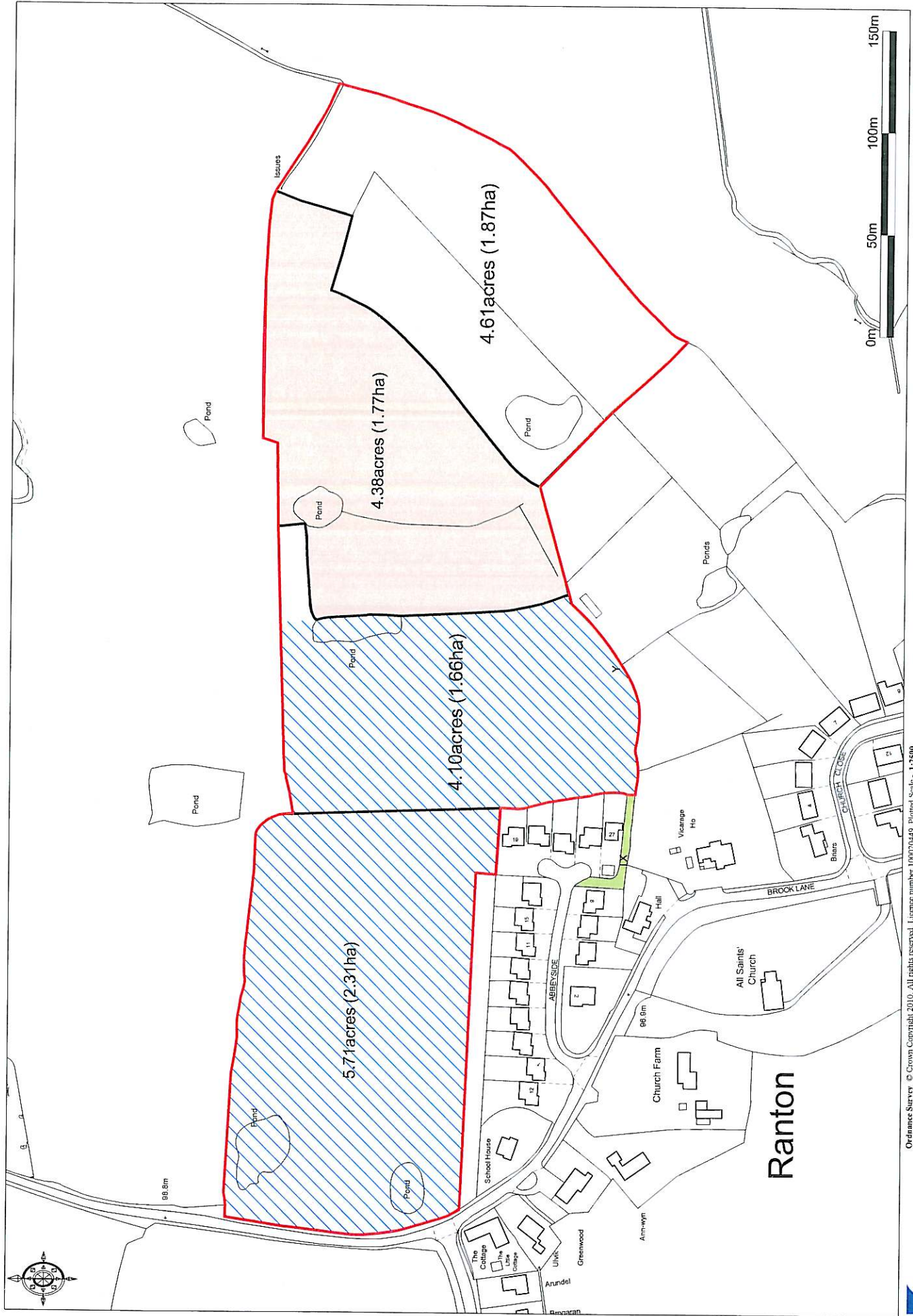

Ordnance Survey © Crown Copyright 2010. All rights reserved. Licence number 100020449. Plotted Scale - 1:2500

